



PROPERTY ID: R4840159

Referencia catastral: 03103A0040000900000000

DATOS DESCRIPTIVOS DEL INMUEBLE

Localización:
Polígono 4 Parcela 69
EL HOSPITAL. EL PINOS / PINOSO [ALICANTE]

Clase: RÚSTICO
Uso principal: Agrario
Superficie construida:
Año construcción:

CULTIVO			
Subparcela	Cultivo/aprovechamiento	Intensidad Productiva	Superficie m²
0	VR Viñedos regadío	03	42.248

PARCELA

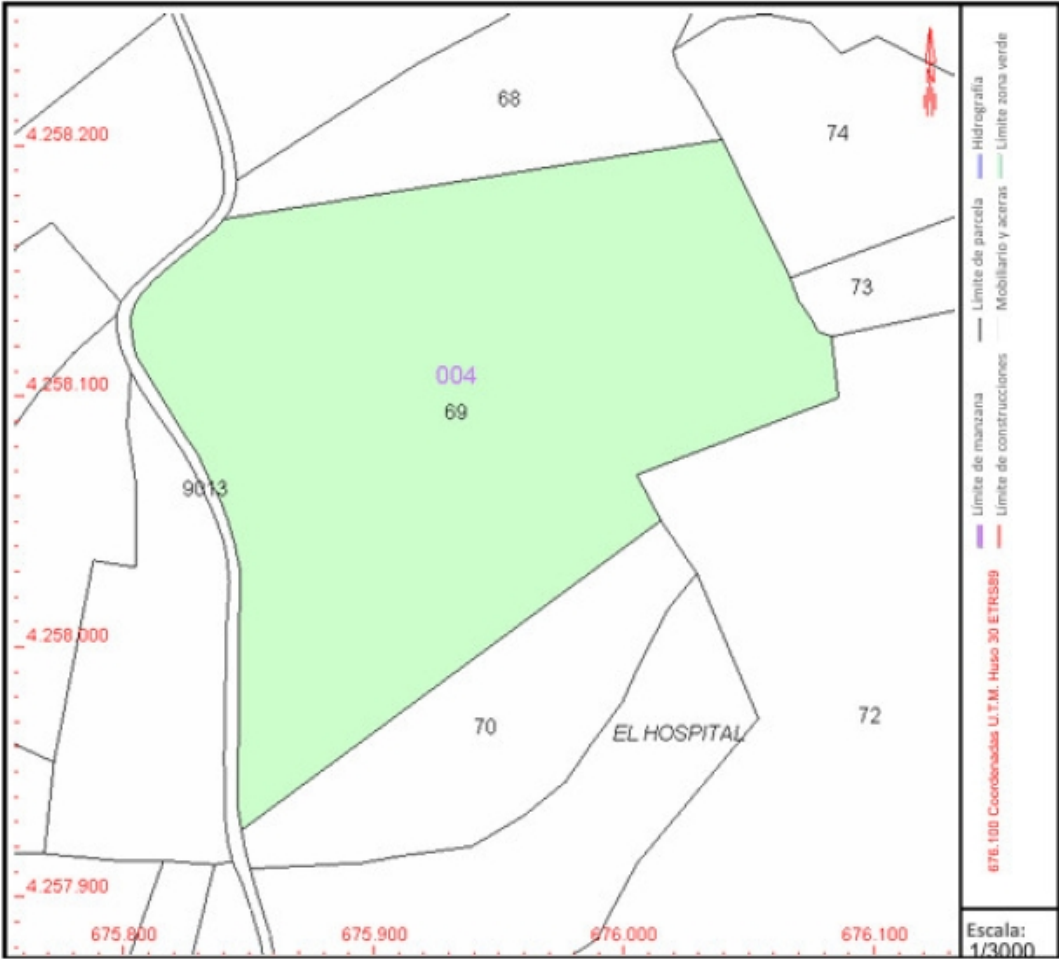

Superficie gráfica: 42.248 m2
Participación del inmueble: 100,00 %
Tipo:



Land for sale in Pinoso

€79,995

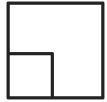
This building plot of 42,248 m² is situated in a peaceful hamlet just outside Pinoso. The land benefits from irrigation water and offers the potential to be divided into four separate plots. Local regulations allow for construction of up to 2% of the plot size, with the option to build on two levels, providing flexibility for multiple projects or a...

 0 m²	 42248
 0	 0



+34 609 97 72 62



www.homes-abroad.com



info@homes-abroad.com